

A+/-0.0625	B+/-0.0625	C+/-0.0625	D+/-0.0625	E (REF)	F+/-0.0625	G+/-0.0313	H+/-0.005	T
0.750	1.250	1.750	0.750	0.437	0.437	0.218	0.205	0.048

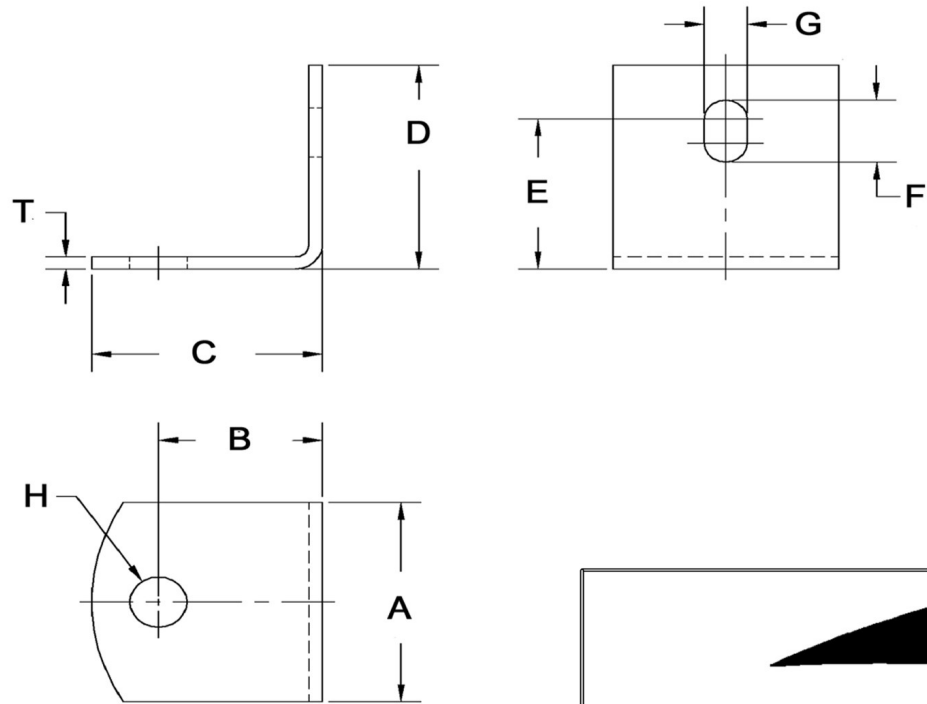

Dimensions in Inches



SEASTROM MANUFACTURING CO., INC.
 456 SEASTROM STREET
 TWIN FALLS, IDAHO 83301
 (208) 737-4300 FAX (208) 734-7222

ALL INFORMATION
 COPYRIGHTED BY
 SEASTROM MFG. ©

PART NO.:	5950-2
PART NAME:	Brackets, Mounting
MATERIAL:	Cold Rolled Steel
HEAT TREAT:	Please refer to Material & Finish Specifications in Engineering Resources
FINISH:	Cadmium Type II (All Dimensions Are Prior To Plating)