

**STYLE 1**

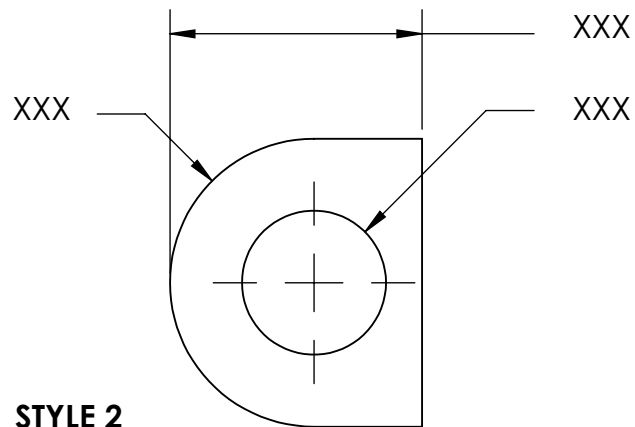

**STYLE 2**

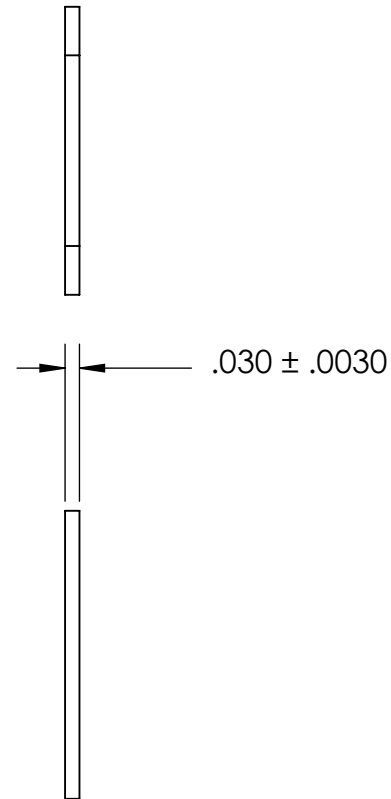

**NOTES:**

1. ZINC PLATE PER ASTM B633, SC1, TYPE II or VI, Yellow
2. STYLE 1
3. DIMENSIONS APPLY PRIOR TO PLATING.

**PROPRIETARY AND CONFIDENTIAL**  
THE INFORMATION CONTAINED IN THIS DRAWING IS THE SOLE PROPERTY OF SEASTROM MANUFACTURING. ANY REPRODUCTION IN PART OR AS A WHOLE WITHOUT THE WRITTEN PERMISSION OF SEASTROM MANUFACTURING IS PROHIBITED.

DIMENSIONS ARE IN INCHES TOLERANCES: FRACTIONAL $\pm 1/32$ ANGULAR: MACH $\pm 1/2$ Deg TWO PLACE DECIMAL $\pm .01$ THREE PLACE DECIMAL $\pm .005$	NAME	DATE	SEASTROM MFG	
	DRAWN			
	CHECKED		CLIPPED WASHER	
	ENG APPR.			
	MFG APPR.			
MATERIAL	Q.A.			
FINISH	COMMENTS:			
SEE NOTE 1				
DRAWING IS NOT TO SCALE			SIZE	REV.
			A	-
			DWG. NO.	
			5734-7-Z2	
			SHEET 1 OF 1	