

STYLE 1

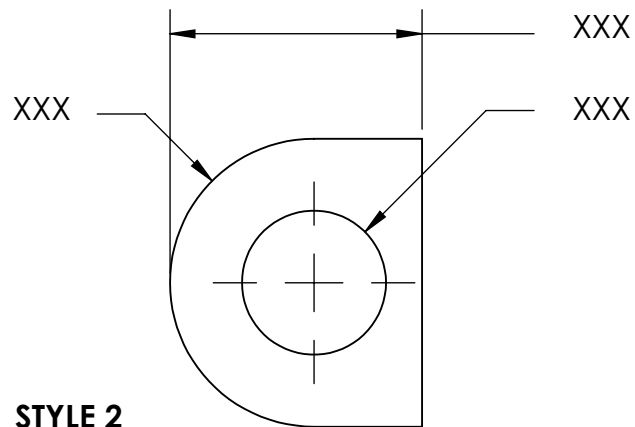

STYLE 2

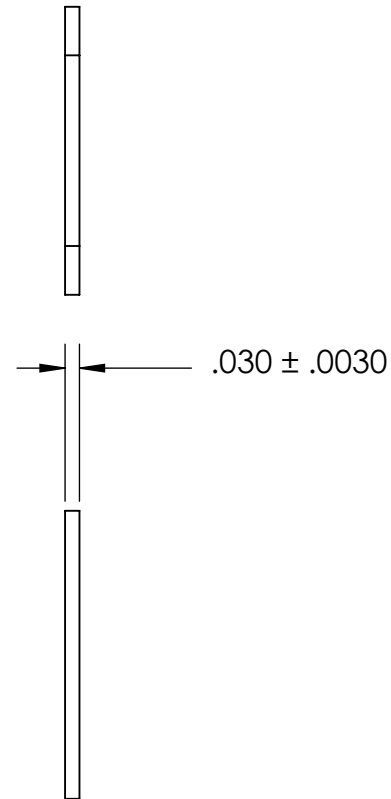

NOTES:

1. ZINC PLATE PER ASTM B633, SC1, TYPE III or V, Clear
2. STYLE 1
3. DIMENSIONS APPLY PRIOR TO PLATING.

PROPRIETARY AND CONFIDENTIAL
 THE INFORMATION CONTAINED IN THIS DRAWING IS THE SOLE PROPERTY OF SEASTROM MANUFACTURING. ANY REPRODUCTION IN PART OR AS A WHOLE WITHOUT THE WRITTEN PERMISSION OF SEASTROM MANUFACTURING IS PROHIBITED.

DIMENSIONS ARE IN INCHES TOLERANCES: FRACTIONAL ±1/32 ANGULAR: MACH ±1/2 Deg TWO PLACE DECIMAL ±.01 THREE PLACE DECIMAL ±.005		NAME	DATE	SEASTROM MFG CLIPPED WASHER		
	DRAWN					
	CHECKED					
	ENG APPR.					
	MFG APPR.					
MATERIAL		Q.A.		COMMENTS:		
COLD ROLLED STEEL						
FINISH SEE NOTE 1				SIZE A	DWG. NO. 5734-16-Z3	REV. -
DRAWING IS NOT TO SCALE				SHEET 1 OF 1		