

SCREW SIZE CLEARANCE HOLE: 8 (TYP)  
SLOTTED BUS BAR - SEE INSET

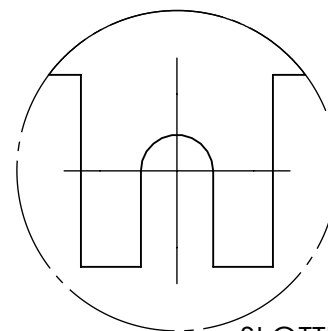

SLOTTED BUS BARS ONLY

#### NOTES

1. TIN PLATE PER ASTM B545 CLASS B

**2. No. TERMINALS: 5**

3. CIRC MIL AREA: 15,915

4. DIMENSIONS APPLY PRIOR TO PLATING.

#### PROPRIETARY AND CONFIDENTIAL

THE INFORMATION CONTAINED IN THIS DRAWING IS THE SOLE PROPERTY OF SEASTROM MANUFACTURING. ANY REPRODUCTION IN PART OR AS A WHOLE WITHOUT THE WRITTEN PERMISSION OF SEASTROM MANUFACTURING IS PROHIBITED.

DIMENSIONS ARE IN INCHES  
 TOLERANCES:  
 FRACTIONAL  $\pm 1/32$   
 ANGULAR: MACH  $\pm 1/2$  Deg  
 TWO PLACE DECIMAL  $\pm .01$   
 THREE PLACE DECIMAL  $\pm .005$

MATERIAL  
 COPPER

FINISH  
 SEE NOTE 1

DRAWING IS NOT TO SCALE

|           | NAME | DATE |
|-----------|------|------|
| DRAWN     |      |      |
| CHECKED   |      |      |
| ENG APPR. |      |      |
| MFG APPR. |      |      |
| Q.A.      |      |      |
| COMMENTS: |      |      |

SEASTROM MFG

BUS BAR

SIZE **A** DWG. NO. 5011-1-5S

REV. -

SHEET 1 OF 1