

## NOTES

1. TIN PLATE PER ASTM B545 CLASS B

2. No. TERMINALS: 20

3. CIRC MIL AREA: 5,093

4. DIMENSIONS APPLY PRIOR TO PLATING.

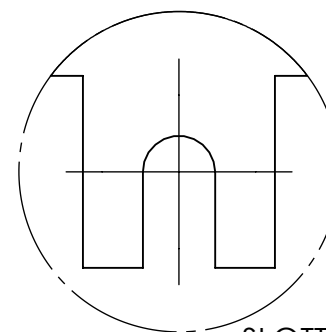

SLOTTED BUS BARS ONLY

### PROPRIETARY AND CONFIDENTIAL

THE INFORMATION CONTAINED IN THIS DRAWING IS THE SOLE PROPERTY OF SEASTROM MANUFACTURING. ANY REPRODUCTION IN PART OR AS A WHOLE WITHOUT THE WRITTEN PERMISSION OF SEASTROM MANUFACTURING IS PROHIBITED.

DIMENSIONS ARE IN INCHES  
TOLERANCES:  
FRACTIONAL  $\pm \frac{1}{32}$   
ANGULAR: MACH  $\pm \frac{1}{2}$  Deg  
TWO PLACE DECIMAL  $\pm .01$   
THREE PLACE DECIMAL  $\pm .005$

MATERIAL  
COPPER

FINISH  
SEE NOTE 1

DRAWING IS NOT TO SCALE

	NAME	DATE
DRAWN		
CHECKED		
ENG APPR.		
MFG APPR.		
Q.A.		
COMMENTS:		

SEASTROM MFG

BUS BAR

SIZE **A** DWG. NO. 5010-2-20

REV. -

SHEET 1 OF 1