

1.156

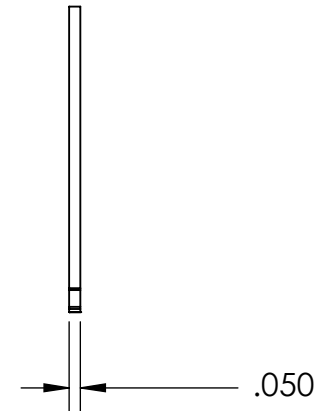
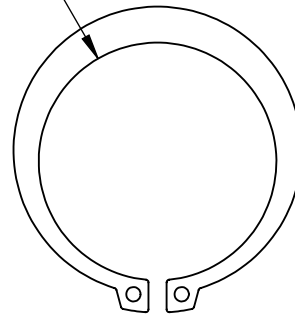

### **SIZING**

SHAFT DIA.: Ø1.250

GROOVE DIA.: Ø1.176

GROOVE WIDTH: Ø.056

### NOTES

1. PHOSPHATE COATING

2. STYLE: EXTERNAL

3. DIMENSIONS APPLY PRIOR TO PLATING.

#### **PROPRIETARY AND CONFIDENTIAL**

THE INFORMATION CONTAINED IN THIS DRAWING IS THE SOLE PROPERTY OF SEASTROM MANUFACTURING. ANY REPRODUCTION IN PART OR AS A WHOLE WITHOUT THE WRITTEN PERMISSION OF SEASTROM MANUFACTURING IS PROHIBITED.

DIMENSIONS ARE IN INCHES  
TOLERANCES:  
FRACTIONAL  $\pm 1/32$   
ANGULAR: MACH  $\pm 1/2$  Deg  
TWO PLACE DECIMAL  $\pm .01$   
THREE PLACE DECIMAL  $\pm .005$

MATERIAL  
**SPRING STEEL**

FINISH  
**SEE NOTE 1**

DRAWING IS NOT TO SCALE

	NAME	DATE
DRAWN		
CHECKED		
ENG APPR.		
MFG APPR.		
Q.A.		
COMMENTS:		

**SEASTROM MFG**

**RETAINING RING**

SIZE	DWG. NO.	REV.
<b>A</b>	<b>2727-21-125</b>	-

SHEET 1 OF 1