

NOTES

1. NICKEL PLATE PER AMS QQ-N-290 CLASS 1 GRADE G

2. No. TERMINALS: 5

3. CIRC MIL AREA: 15,915

4. DIMENSIONS APPLY PRIOR TO PLATING.

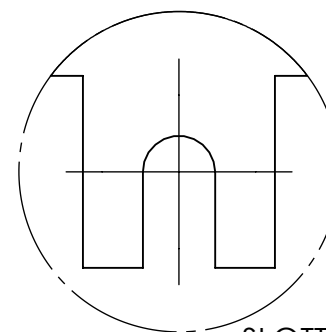

SLOTTED BUS BARS ONLY

PROPRIETARY AND CONFIDENTIAL

THE INFORMATION CONTAINED IN THIS DRAWING IS THE SOLE PROPERTY OF SEASTROM MANUFACTURING. ANY REPRODUCTION IN PART OR AS A WHOLE WITHOUT THE WRITTEN PERMISSION OF SEASTROM MANUFACTURING IS PROHIBITED.

DIMENSIONS ARE IN INCHES
TOLERANCES:
FRACTIONAL $\pm 1/32$
ANGULAR: MACH $\pm 1/2$ Deg
TWO PLACE DECIMAL $\pm .01$
THREE PLACE DECIMAL $\pm .005$

MATERIAL
COPPER

FINISH
SEE NOTE 1

DRAWING IS NOT TO SCALE

	NAME	DATE
DRAWN		
CHECKED		
ENG APPR.		
MFG APPR.		
Q.A.		
COMMENTS:		

SEASTROM MFG

BUS BAR

SIZE	DWG. NO.	REV.
A	5011-1-5-N	-

SHEET 1 OF 1