

.375 ± .002

Ø.250 ± .003

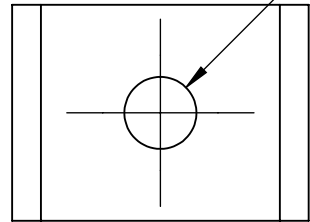

NOTES

1. SPRING STEEL, ANNEALED

2. QUENCH & TEMPER 80-83 HR15N

3. NONE

4. DIMENSIONS ARE TAKEN WITH THE PART CLAMPED TO A FLAT SURFACE AND A DUMMY COMPONENT IN PLACE.

PROPRIETARY AND CONFIDENTIAL

THE INFORMATION CONTAINED IN THIS DRAWING IS THE SOLE PROPERTY OF SEASTROM MANUFACTURING. ANY REPRODUCTION IN PART OR AS A WHOLE WITHOUT THE WRITTEN PERMISSION OF SEASTROM MANUFACTURING IS PROHIBITED.

DIMENSIONS ARE IN INCHES
TOLERANCES:
FRACTIONAL ± 1/32
ANGULAR: MACH ± 1/2 Deg
TWO PLACE DECIMAL ± .01
THREE PLACE DECIMAL ± .005

MATERIAL
SEE NOTE 1

HEAT TREAT
SEE NOTE 2

FINISH
SEE NOTE 3

	NAME	DATE
DRAWN		
CHECKED		
ENG APPR.		
MFG APPR.		
Q.A.		
COMMENTS:		

SEASTROM MFG

SPRING CLIP

SIZE **A** DWG. NO. 4505-18X35-37-2 REV. -

DRAWING IS NOT TO SCALE

SHEET 1 OF 1